



Ethan Willett
0844752021
ethan.w@newpointproperty.co.za

Contact Head Office

010 0354431

Office 40A
Eden Meadows Complex
1 Van Riebeeck Avenue
Greenstone
1609

961m² Warehouse To Let in Laser Park



Web Ref 961EWLPTLU27

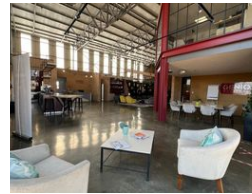

R72,075 pm

Gross Monthly Rental R72,075 Excl. VAT
Monthly Rates R1 Excl. VAT

Monthly Levy R1 Excl. VAT

0 8

Industrial property to Rent in Laserpark, Roodepoort

This spacious 961sqm industrial warehouse unit is available to rent immediately at R72,075 per month (excluding VAT). Located in a clean, well-maintained business park with 24-hour security, the property offers peace of mind and ease of access, just off the main Beyers Naude Drive in Laserpark, Roodepoort. The warehouse features a functional and open layout with excellent roof height and generous floor space, making it ideal for storage, light manufacturing, or logistics operations. A large on-grade roller shutter door provides convenient access for loading and offloading goods.

Inside, the unit includes a neat and practical office area, along with a solid concrete mezzanine level that offers additional storage

Features

Zoning Industrial

Interior

Floor Loading Cap. 2 Tn/m²
Air Conditioning Yes
Power 3 Phase Yes
Power Amps 100

Exterior

Security Yes
Open Parking Bays 8

Sizes

Floor Size 961m²

Extras

24 Hour Response Fibre

