



**Donovan Saunders**

Candidate Property Practitioner  
Registered with PPRA  
(FFC 121 151 8)

0743713355

[donovan@newpointproperty.co.za](mailto:donovan@newpointproperty.co.za)

Contact Head Office

010 0354431

Office 40A  
Eden Meadows Complex  
1 Van Riebeeck Avenue  
Greenstone  
1609

24,850m<sup>2</sup> Warehouse To Let in Glen Marais

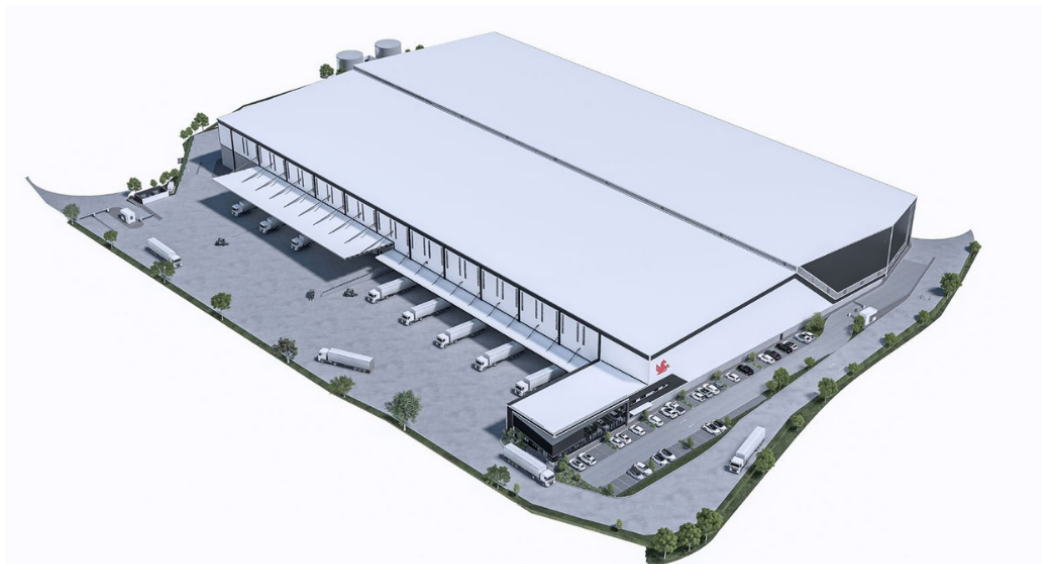

Web Ref DS24850PTL

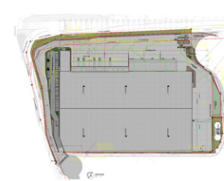

R2,360,750 pm

Gross Monthly Rental R2,360,750 Excl. VAT

10 10

**UNDER CONSTRUCTION!** New A-grade 24850sqm industrial warehouse in Glen Marais!

This state-of-the-art 24,850sqm industrial warehouse, currently under construction and set for completion in August 2025, presents an exceptional opportunity for logistics, distribution, and storage operations. Strategically located in the fast-developing Glen Marais precinct, the facility offers quick and easy access to major highways and O.R. Tambo International Airport, ensuring seamless connectivity for businesses that require efficient transportation links. Designed to meet the highest modern industrial standards, the warehouse features multiple dock levelers and large roller shutter doors, enabling smooth loading and offloading processes.

The warehouse boasts excellent internal height, allowing for maximum racking efficiency, while a full sprinkler system ensures fire

## Features

**Zoning** Industrial

### Interior

Power 3 Phase Yes

### Exterior

Security Yes  
Covered Parking Bays 10  
Open Parking Bays 10

### Sizes

Floor Size 24,850m<sup>2</sup>  
Land Size 47,222m<sup>2</sup>  
Building Height 15m

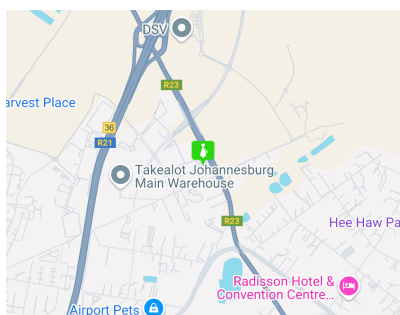

<https://www.newpointproperty.co.za>